

Acoustic Guitar Pickup Installation Instructions

Bartolini Acoustic Guitar Soundhole Pickups are designed to be installed on the bridge side of a 3-1/2" to 4-1/2" soundhole for the best tonal response.

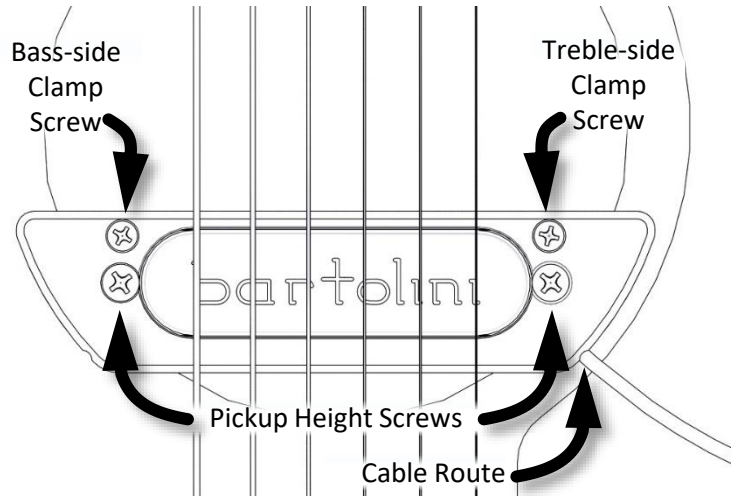

1 - Gently press the cable into the cable groove on the back of the bracket. It should fit just snug enough to hold it in place during installation so that it can provide cable control and strain relief while playing.

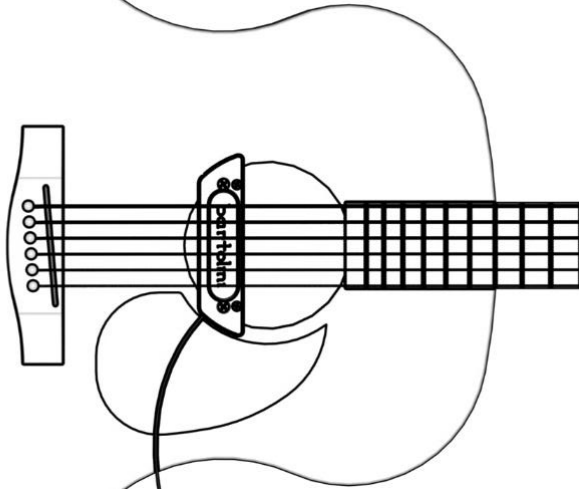
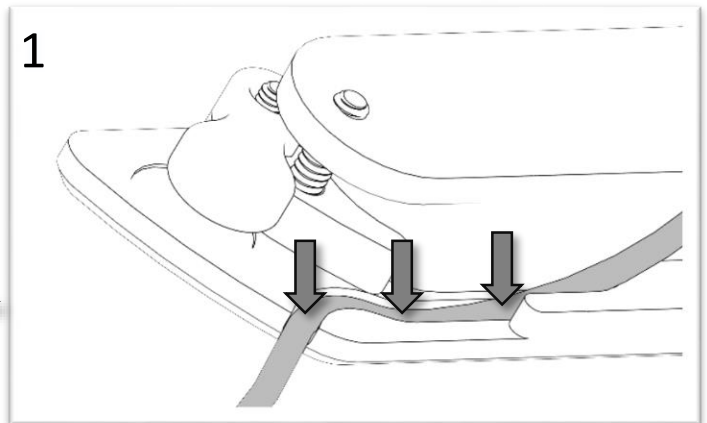

2 - Loosen the high E and B strings if necessary to insert the pickup from the treble-side of the soundhole. Catch the bass end of the bracket on the bass side of the soundhole and guide the pickup into place so it stops against the bridge end of the soundhole. Ensure it is aligned with the bridge.

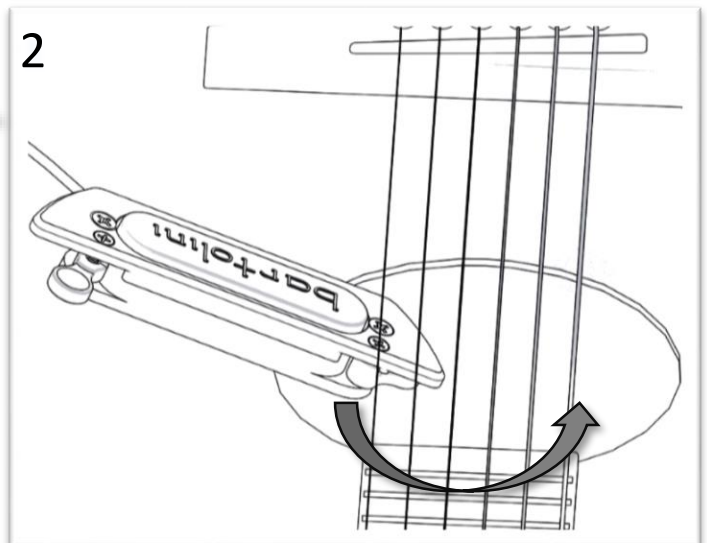

3 - Once in place, rotate the treble-side clamp and gently tighten the screw with a #1 Philips screwdriver. Gently tighten the bass-side clamp screw. Don't overtighten the clamps – they will hold the pickup in place without being too tight.

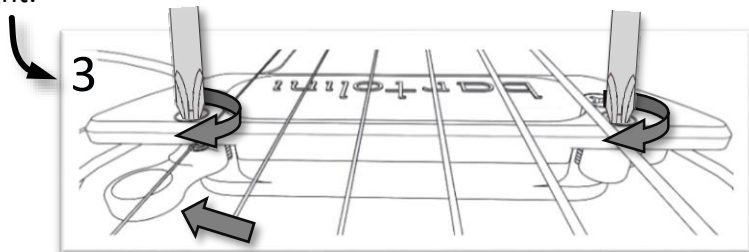

4 - Adjust the pickup height as close to the strings as you are comfortable playing. Fret the low and high E strings as the highest fret and ensure the string will not hit the pickup when you play your most powerful notes.

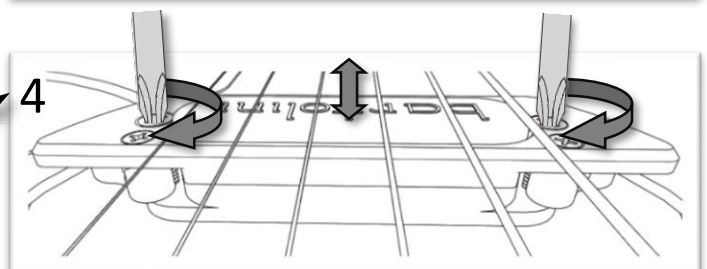

Bartolini pickups are hand assembled in California from quality materials and carry a 1 year warranty against defects in materials and workmanship.